

Ausgabe:
16.10.

Stand
27.11.13

GGBL

1KHA 13/14

Übungsblatt

Blatt, Thema:

AK	9/15	Hagia Sophia
Aschauer	13/15	Invalidendom, Paris
Bocsek		Fenster 13.11. — 27.11.
Bubalovic	8/15	Amun-Tempel in Luxor (Theben), Ägypten
Čelebić	8/15	San Vitale, Ravenna
Djondjević	8/15	HATHOR-TEMPEL, DENDERA
Falschlehner	10/15	Jakobskirche, Toulouse
Joksch	12/15	Horus-Tempel in EDFU, ÄGYPTEN, BEGINN 237 v. CHR.
Kiencltik	12/15	Schiffe Hagia Sophia
Kaufmann		Moschee Edirne 13.11. — 27.11.
Manukovic	15/15	Konstantinopel, Hagia Sophia
Owitsch	8/15	Hagia Irene
Pham Ky	10/15	Megalithischer Tempel, Mrajra, Malta
Pelaha	13/15	KATHEDRALE SAINT-PIERRE
Podringwalder	12/15	Vergleichende Stilkunde „Säulen & Gebälk“
Rafie	10/15	Schehzade-Moschee Istanbul
Schweiger	14/15	KARLSKIRCHE WIEN
Stefanovic	11/15	Pfalzkapelle, AACHEN 777-774 N. CHR.
Tekin	11/15	Vergleichende Stilkunde „Säulen und Gebälk“
Tok	9/15	Gulbarga, Freiheitsmoschee
Vzuvlovic	9/15	SALOMONISCHER TEMPEL, JERUSALEM 920 CHR.
Yilshitz A.	12/15	Moschee
Filipovic	15/15	ABTEIKIRCHE SAINTE-FOY, CONQUES

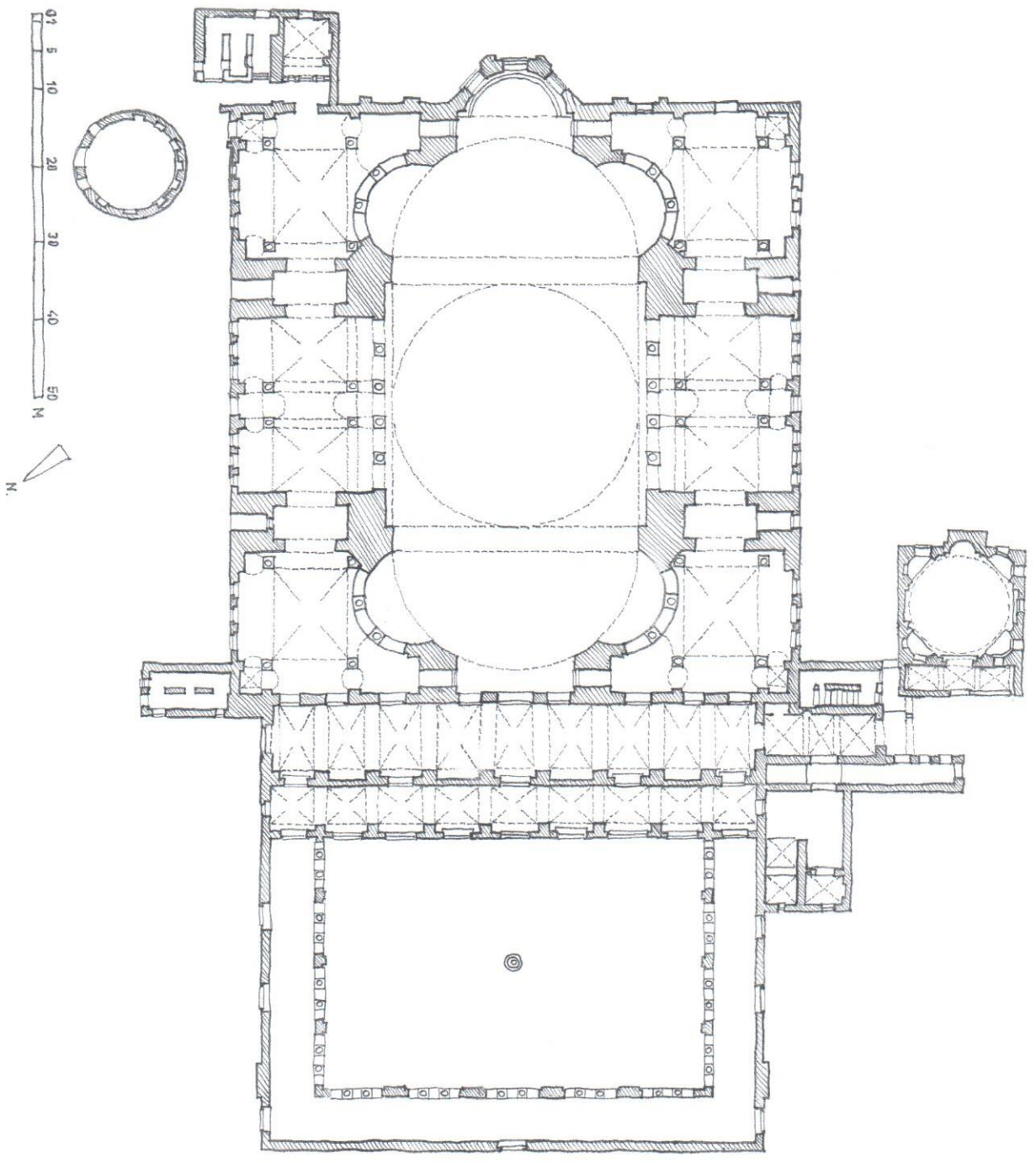

Konstantinopel, Hagia Sophia, 532-537.

15/15 +

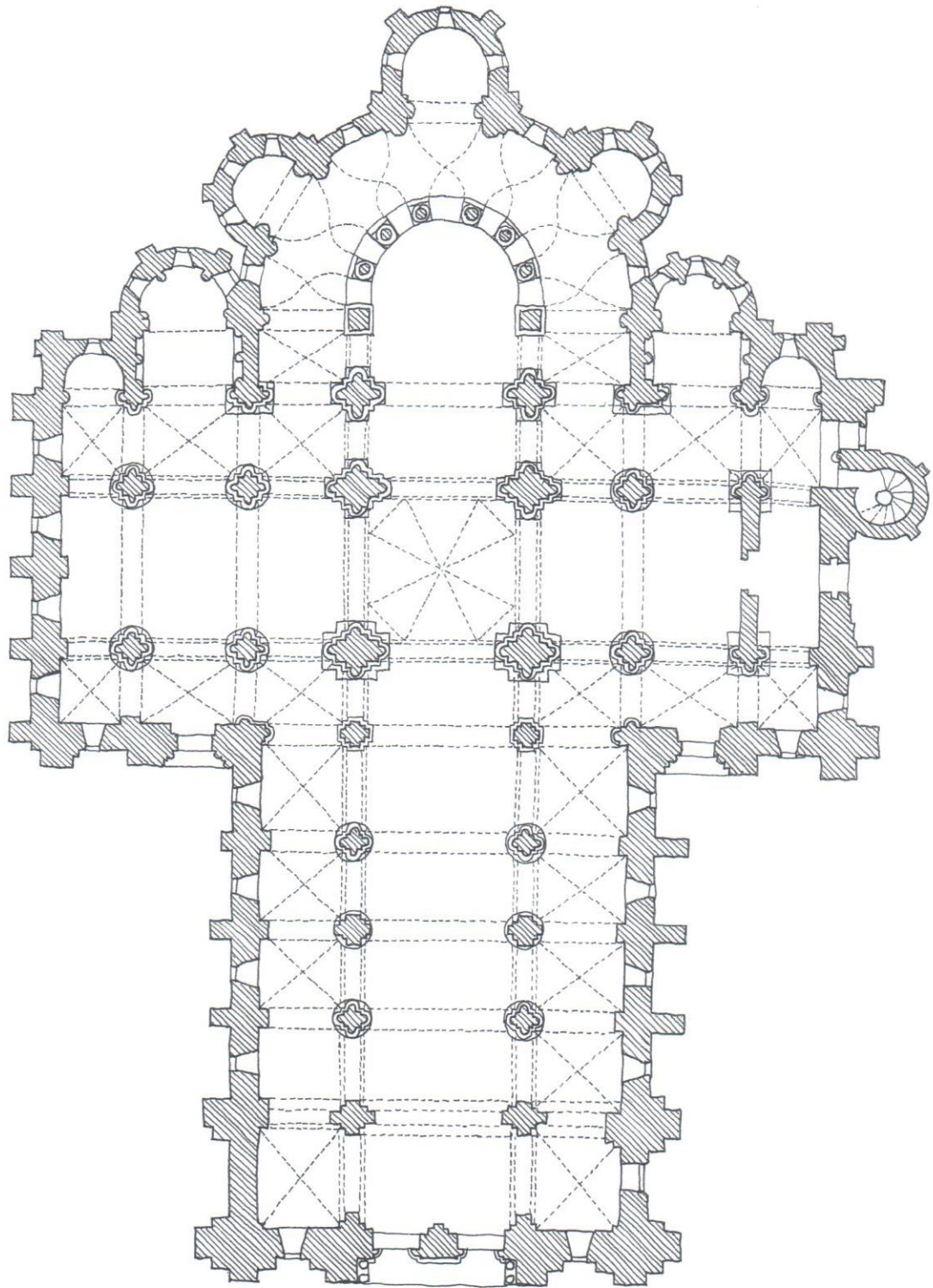

ABTEIKIRCHE SAINTE-FOY, CONQUES (F), 1150

0 1 5 10 15 M

15/15 +
bravo!

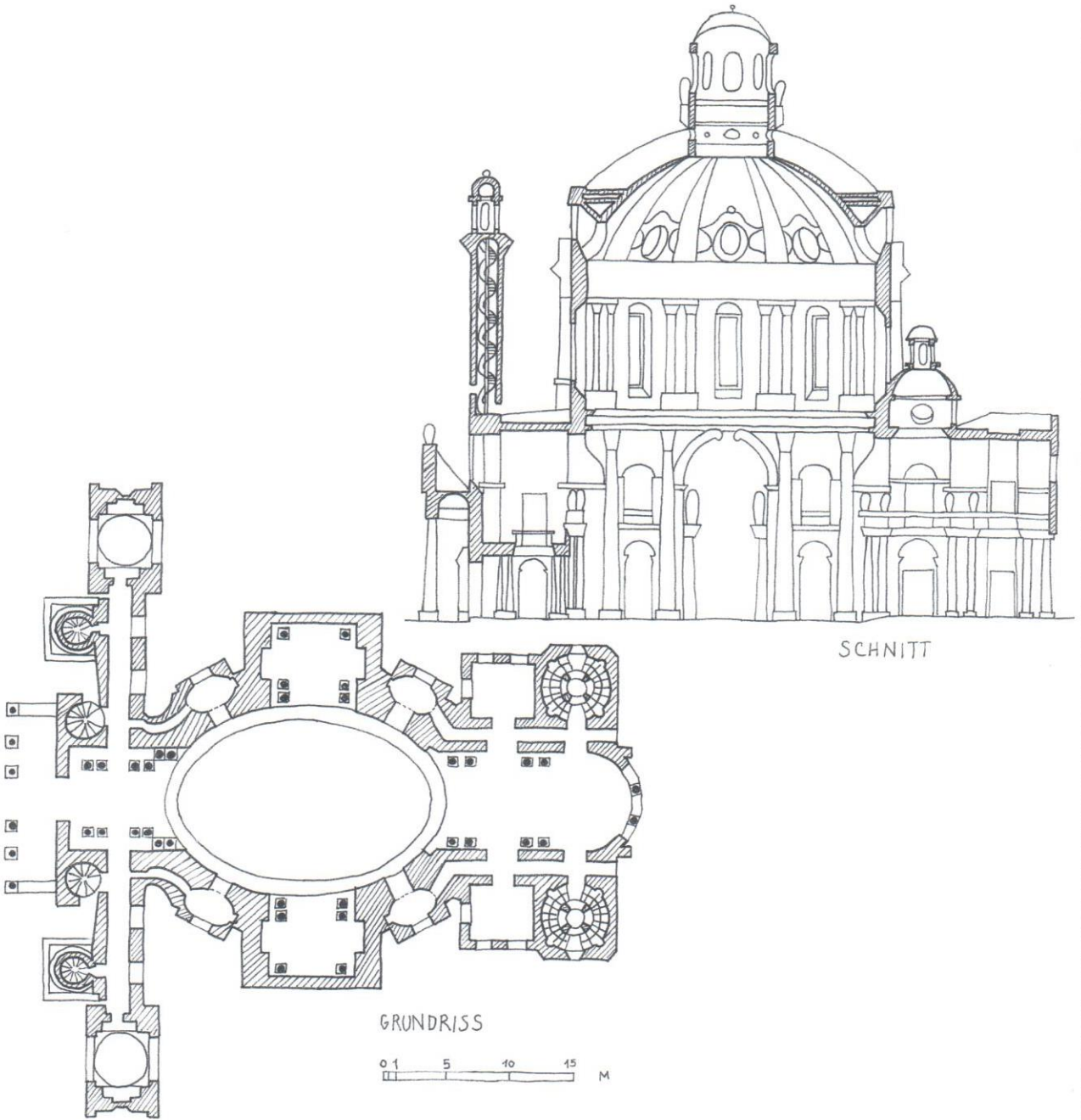

KARLSKIRCHE, WIEN 1737

14/15

+ N

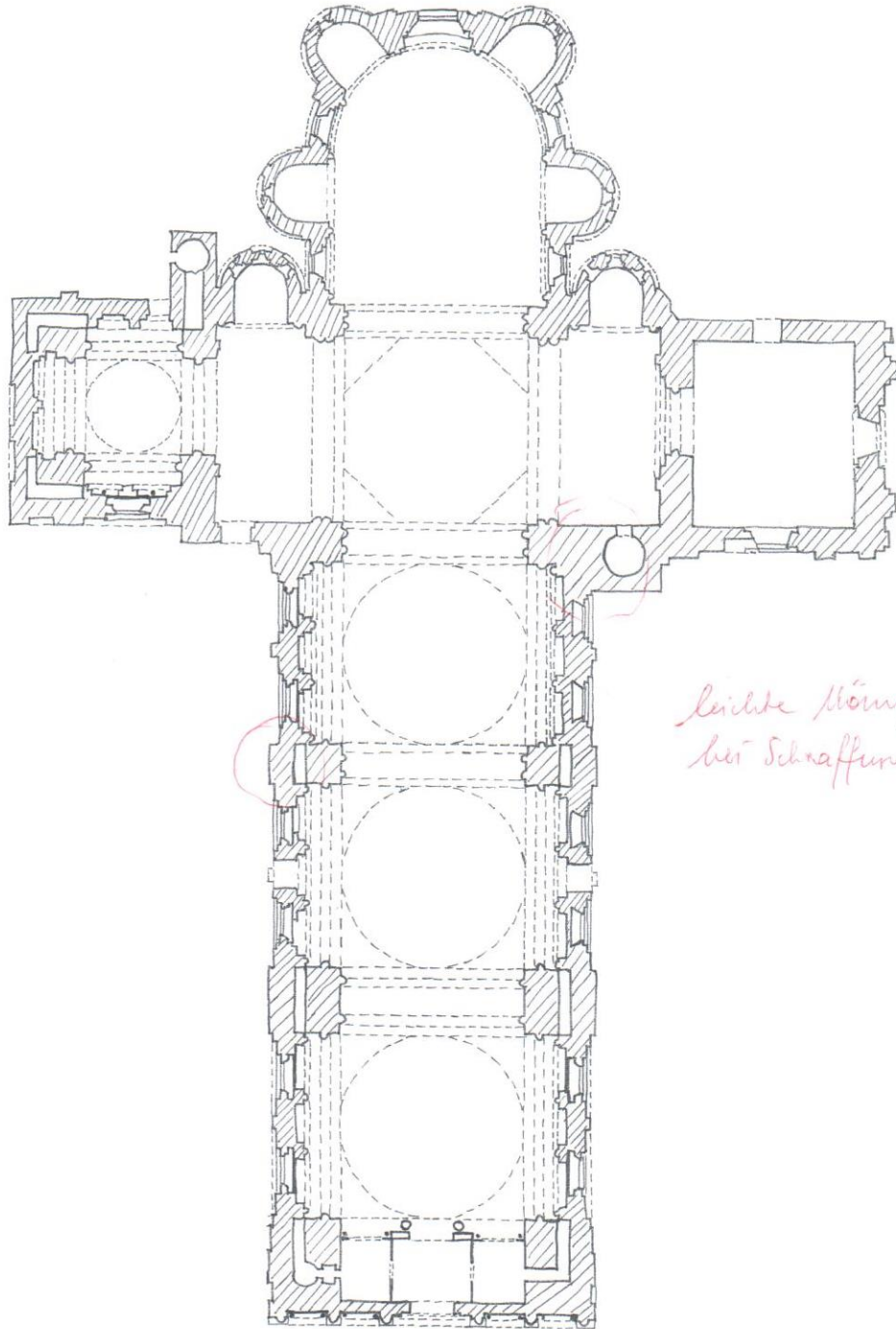

leichte Mönchel
bei Schnaffuren

KATHEDRALE SAINT-PIERRE, ANGOULEME (F), 1110

1 Maßstab

13/15 + 2

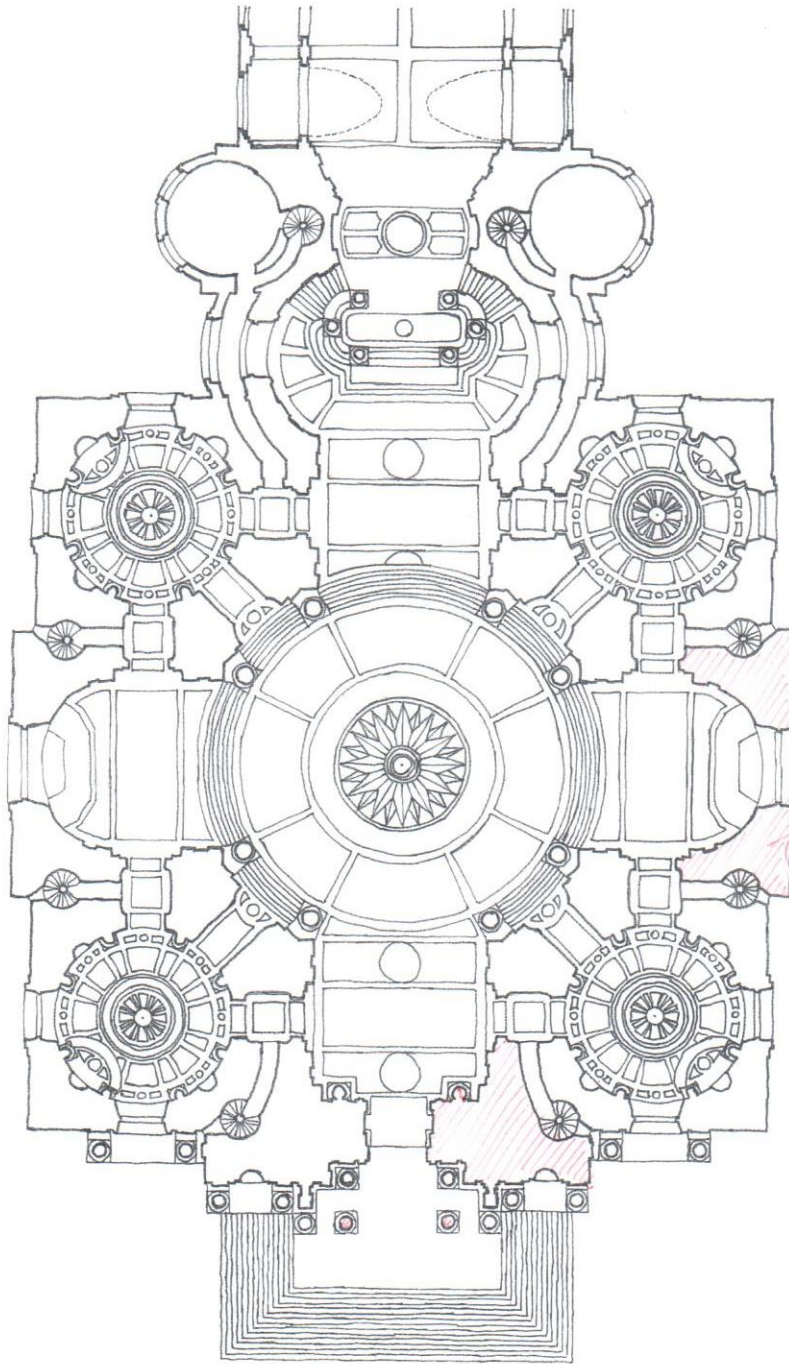

+ Schraffieren



INVALIDENDOM, PARIS 1676 N. CHR.

*+ w
13/15*

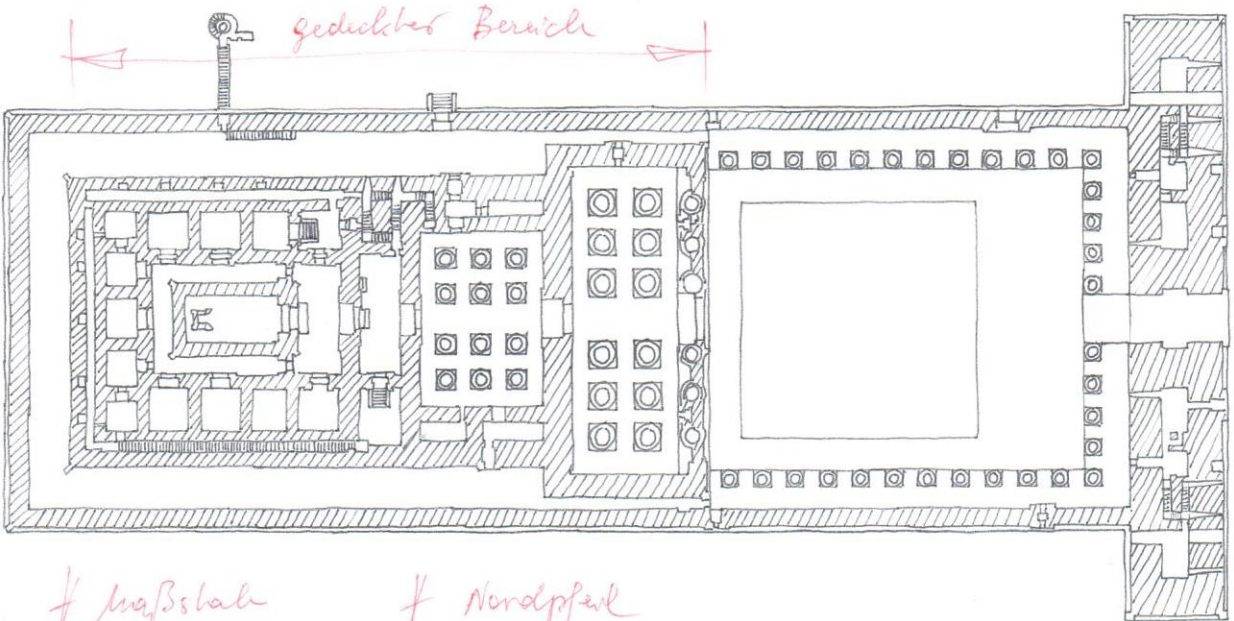
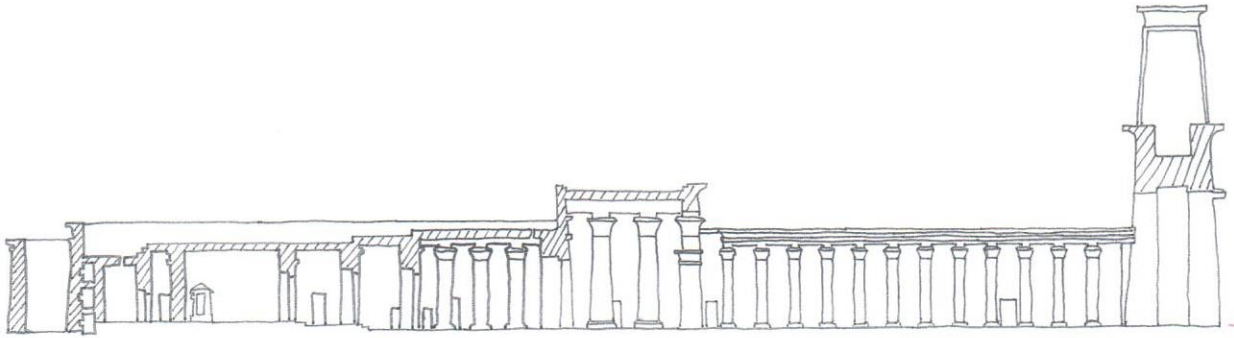

HORUS- TEMPEL IN EDFU, ÄGYPTEN, BEGINN 237 v. CHR.

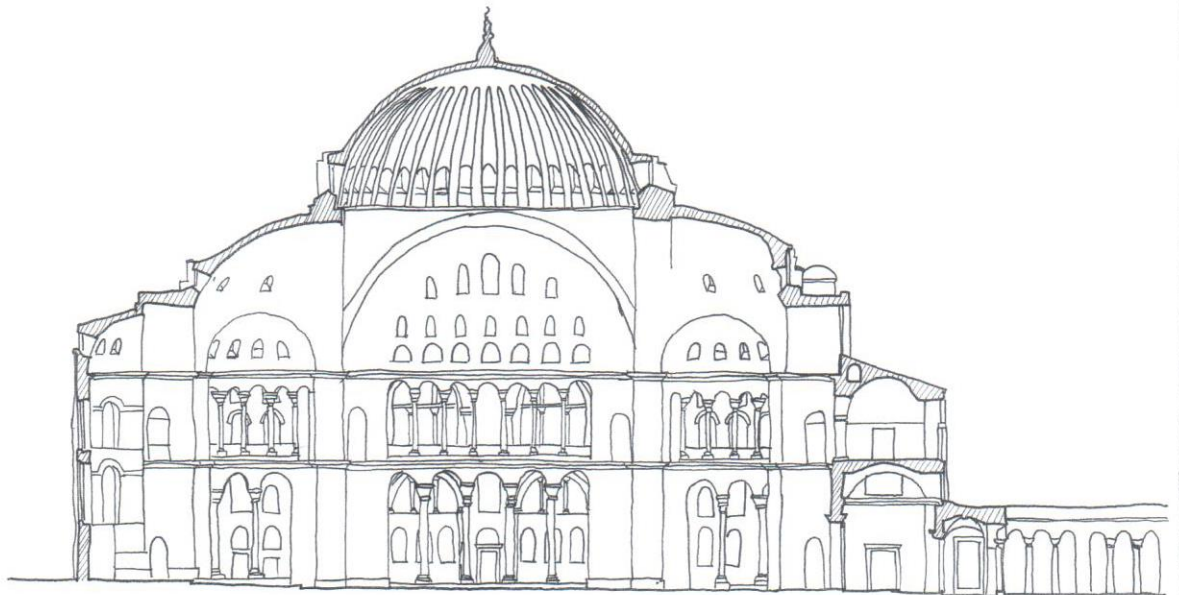
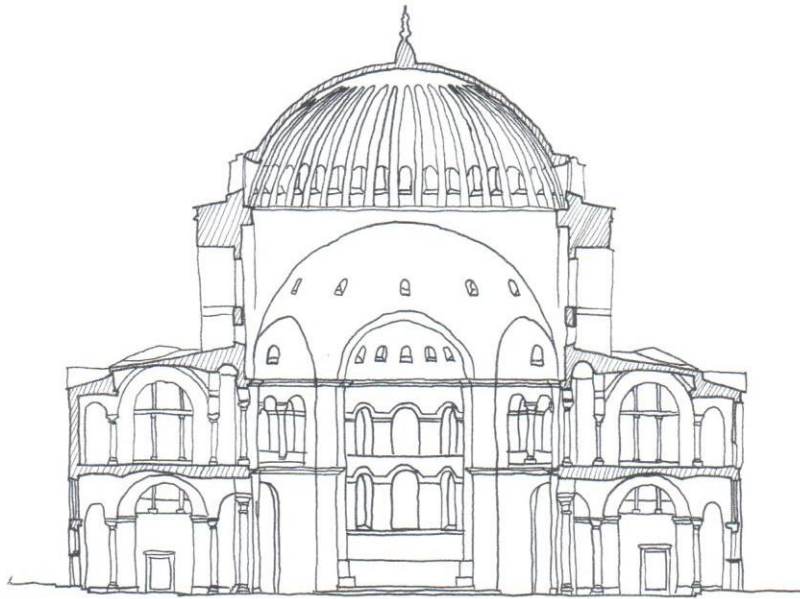

Konstantinopel, Hagia Sophia. 532-537

Kreisbach, Jahr

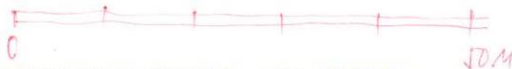

12/15 \pm \sim

Istanbul, Schehzade-Moschee

1544 - 1548

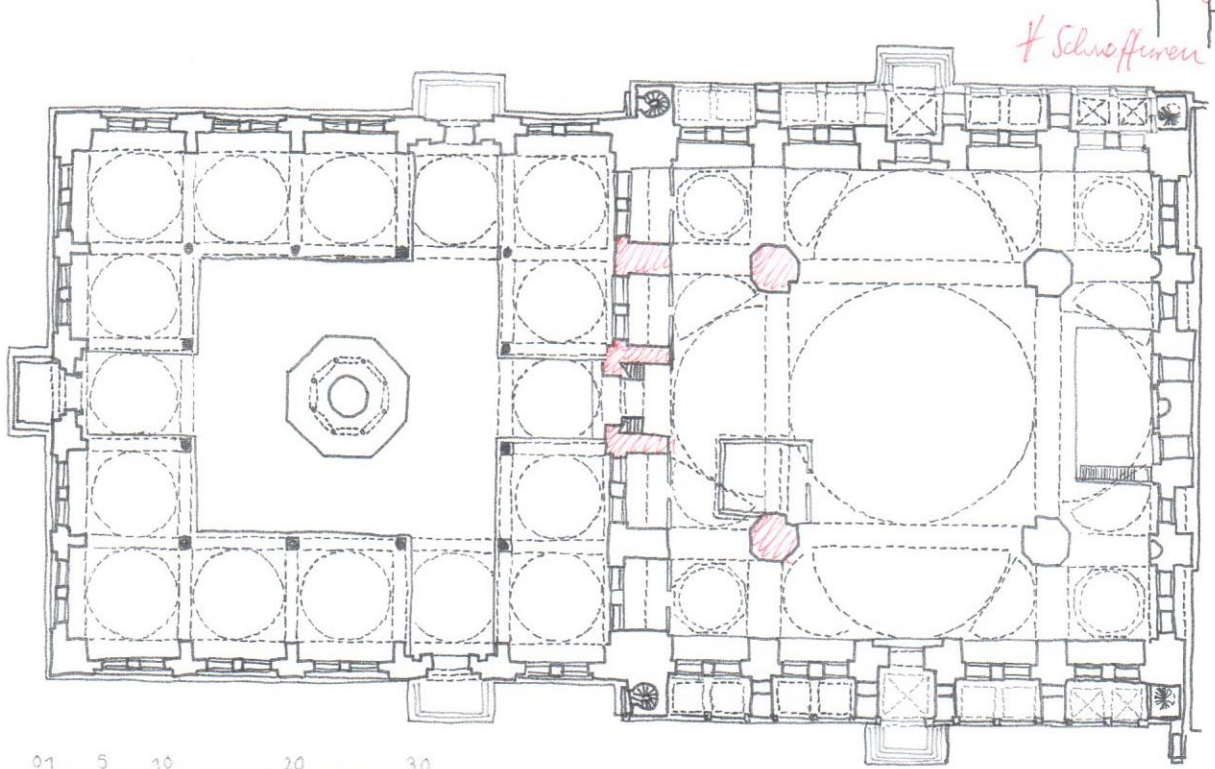
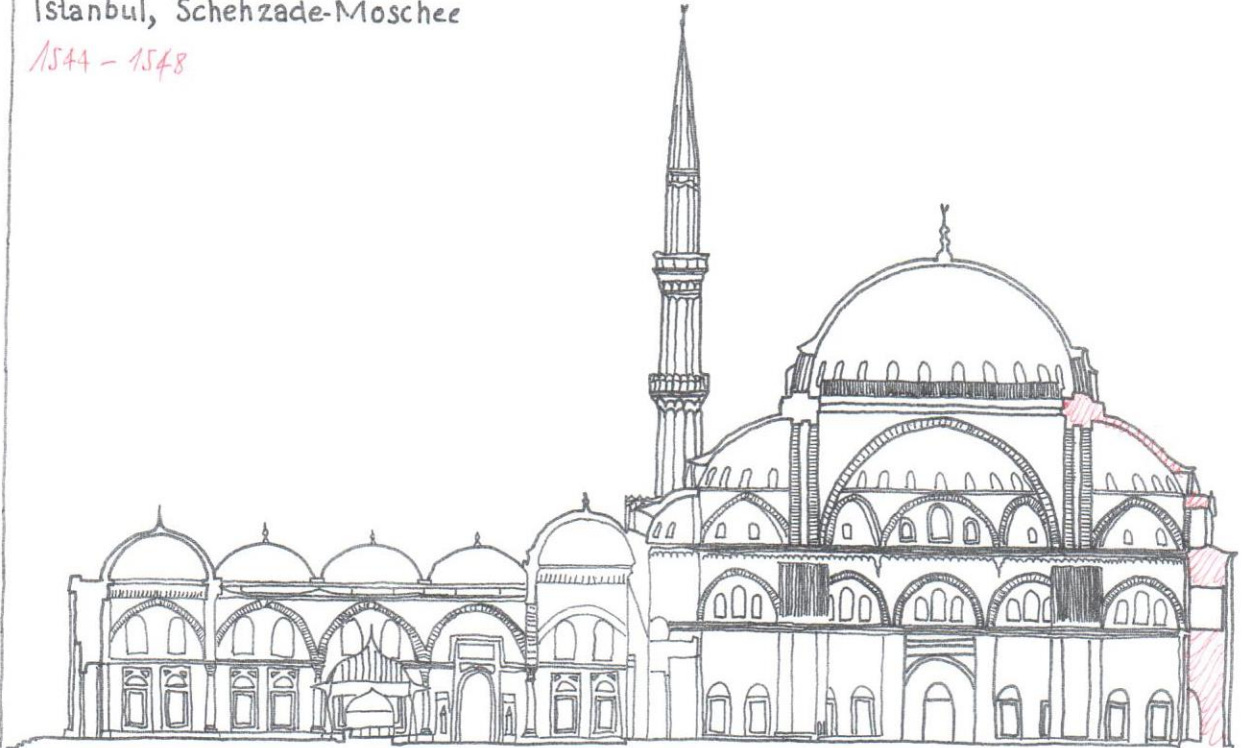

+ Schnefferen

0 1 5 10 20 30 M

+ Nordpfeile

+ ~
12/15

VERGLEICHENDE STILKUNDE
„SÄULEN UND GEBÄLK“

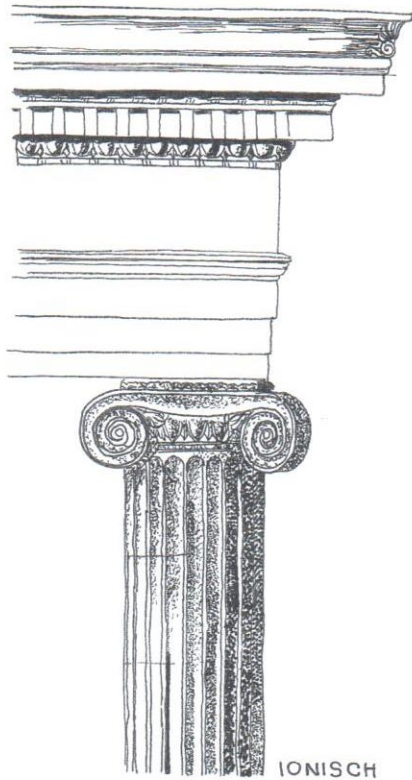

IONISCH

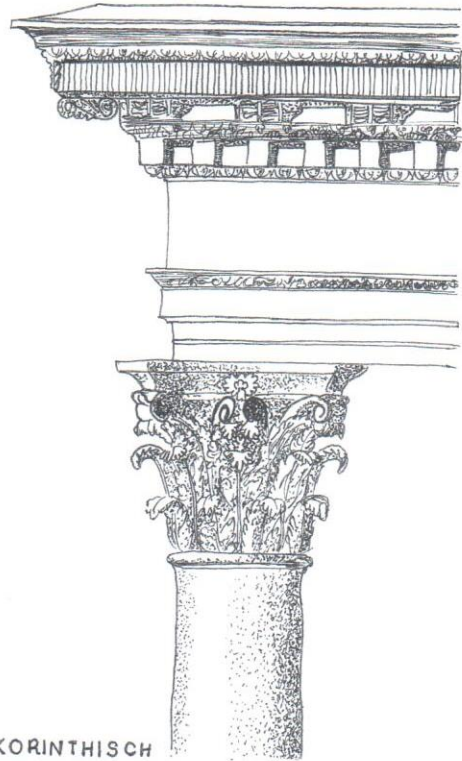

KORINTHISCH

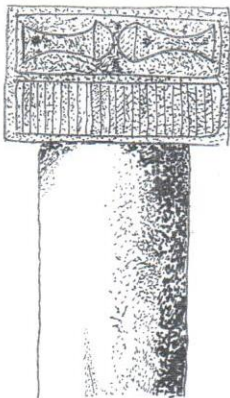

Kubisches Kapitell (Iberisch)
Jaén, Südspanien

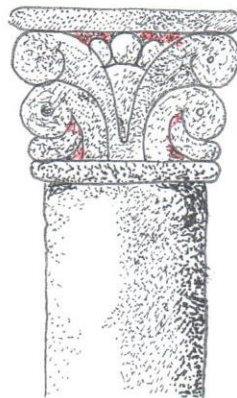

Volutenkapitell aus einem
Etruskergrob bei Gøere

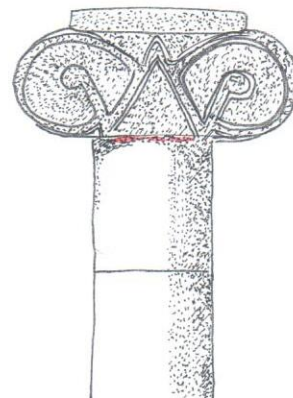

Volutenkapitell
Megidde, Syrien



12/15 + ~

MEGALITHISCHER TEMPEL, MNAJDRA, MALTA. 3000 v. CHR.

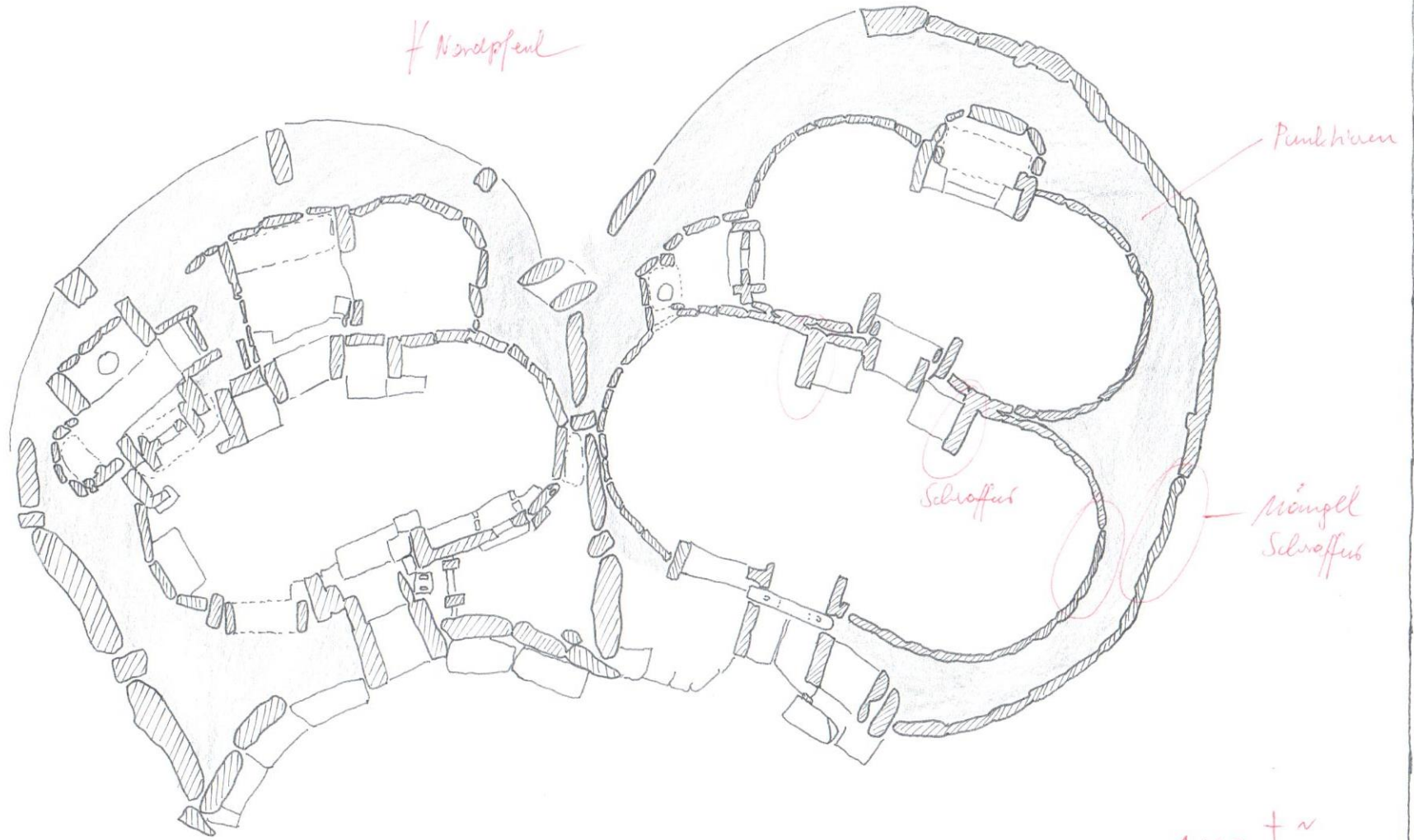

10/15 + ~

VERGLEICHENDE STILKUNDE
„SÄULEN UND GEBÄLK“

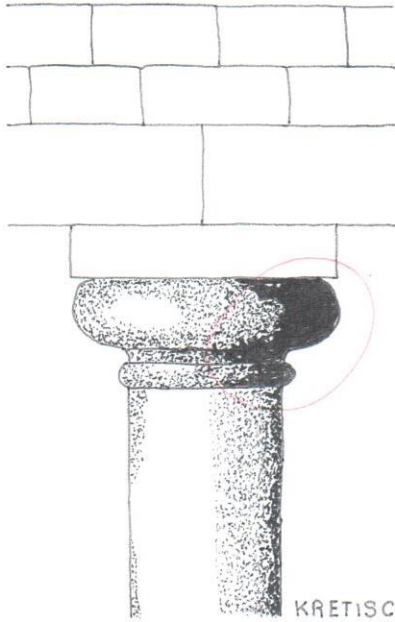

KRETISCH

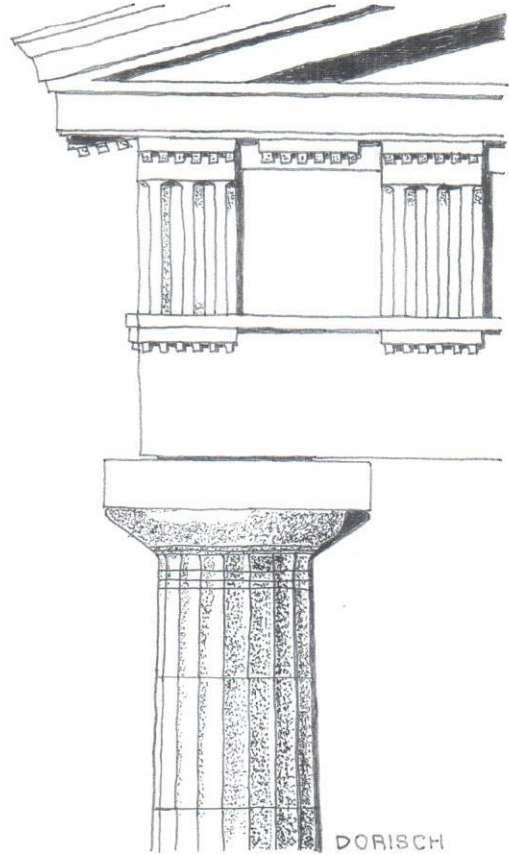

DORISCH

~~DIE DREI KLASSISCHEN~~

KAPITELLE AUS VORKLASSISCHER ZEIT

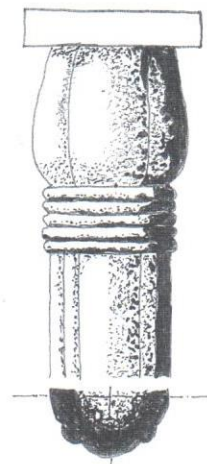
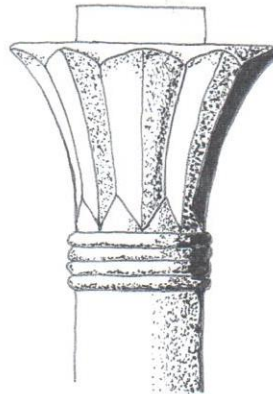
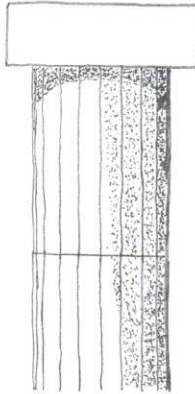

AGYPTISCHE KAPITELLE
geometrisch (sogenannt protodorisch) und nach pflanzlichen Motiven

+ ~
11/15

*Schneffer
Bewegungsbild*

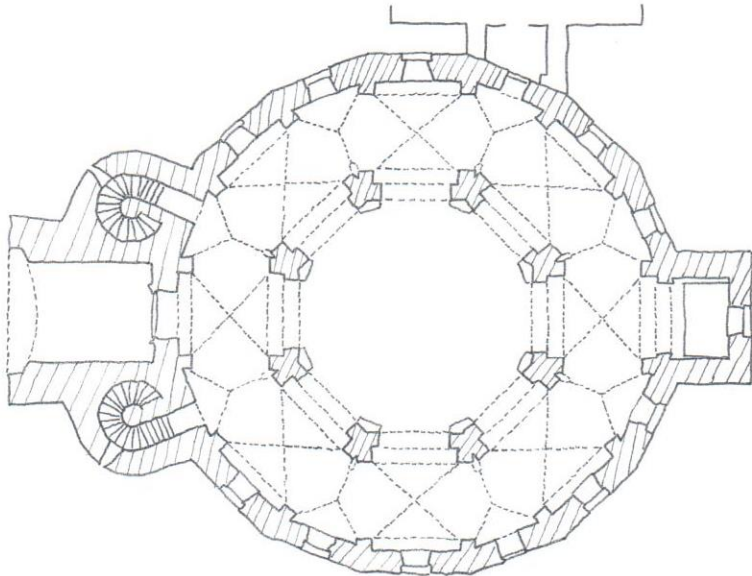
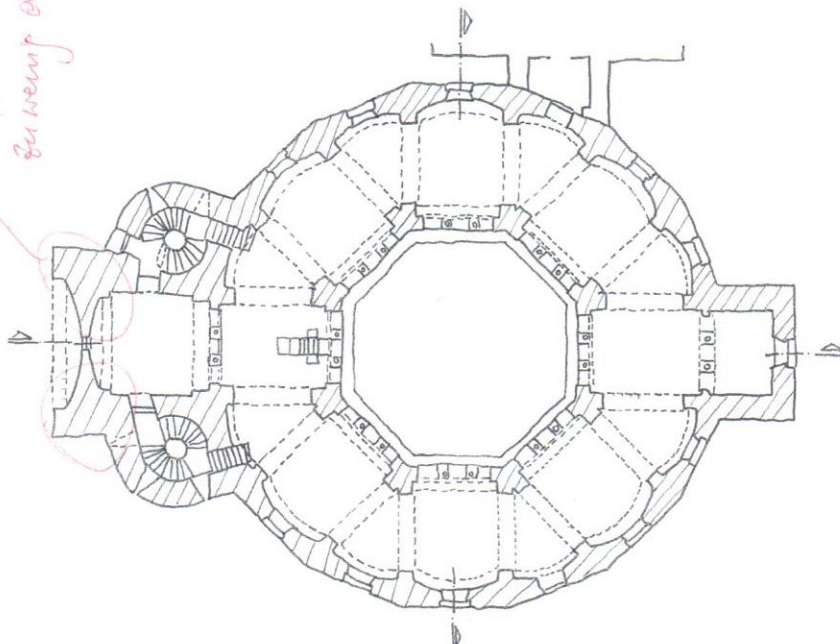

PFALZKAPELLE, AACHEN 777-794 N. CHR.

+ ~

11/15

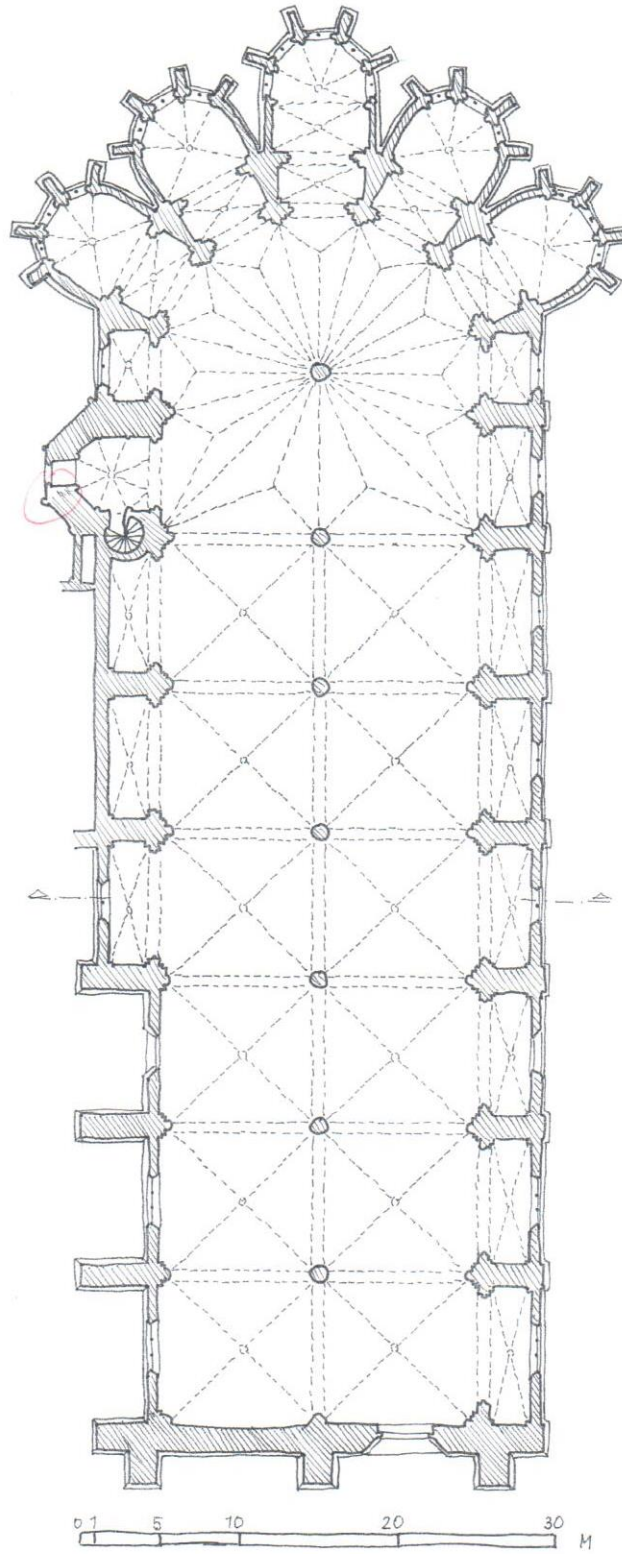

JAKOBINERKIRCHE, TOULOUSE 1260 N.CHR.

Schnitt!

~
10/15

Istanbul, Schehzade-Moschee, 1544 - 1548

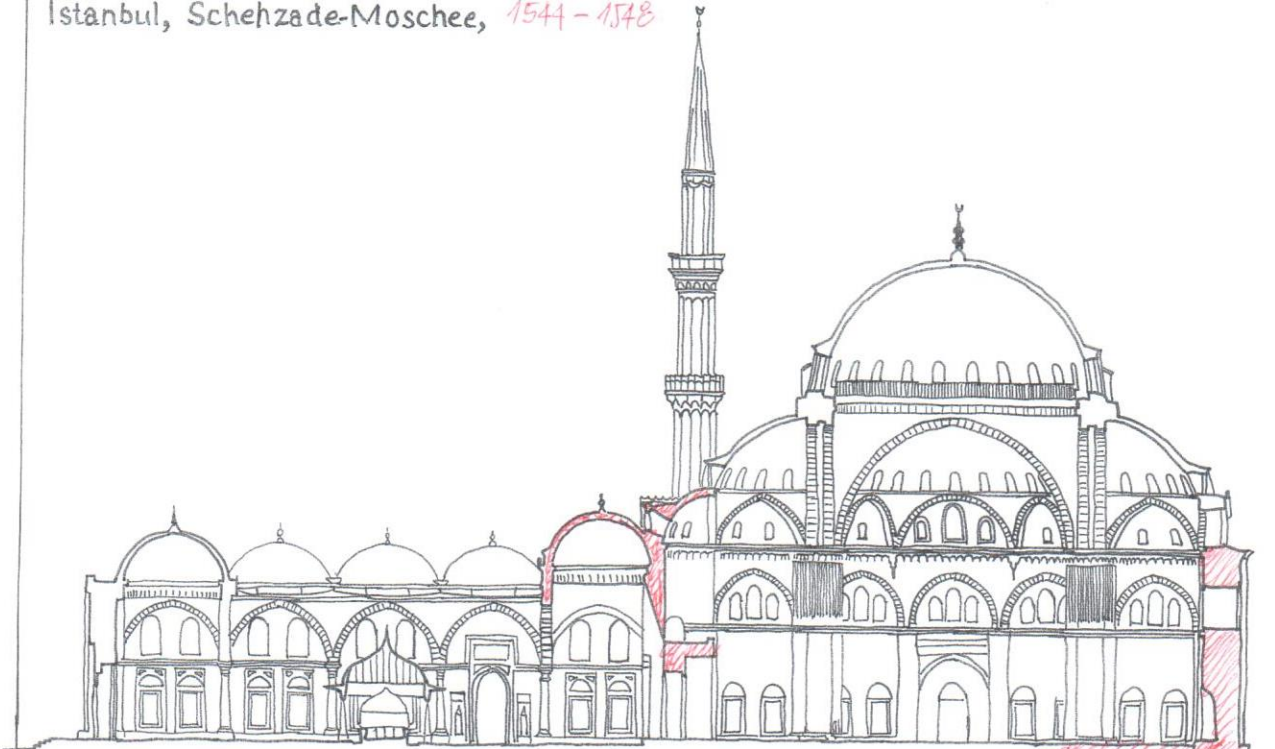

4 Schraffuren

4 Nordsüdpfeile

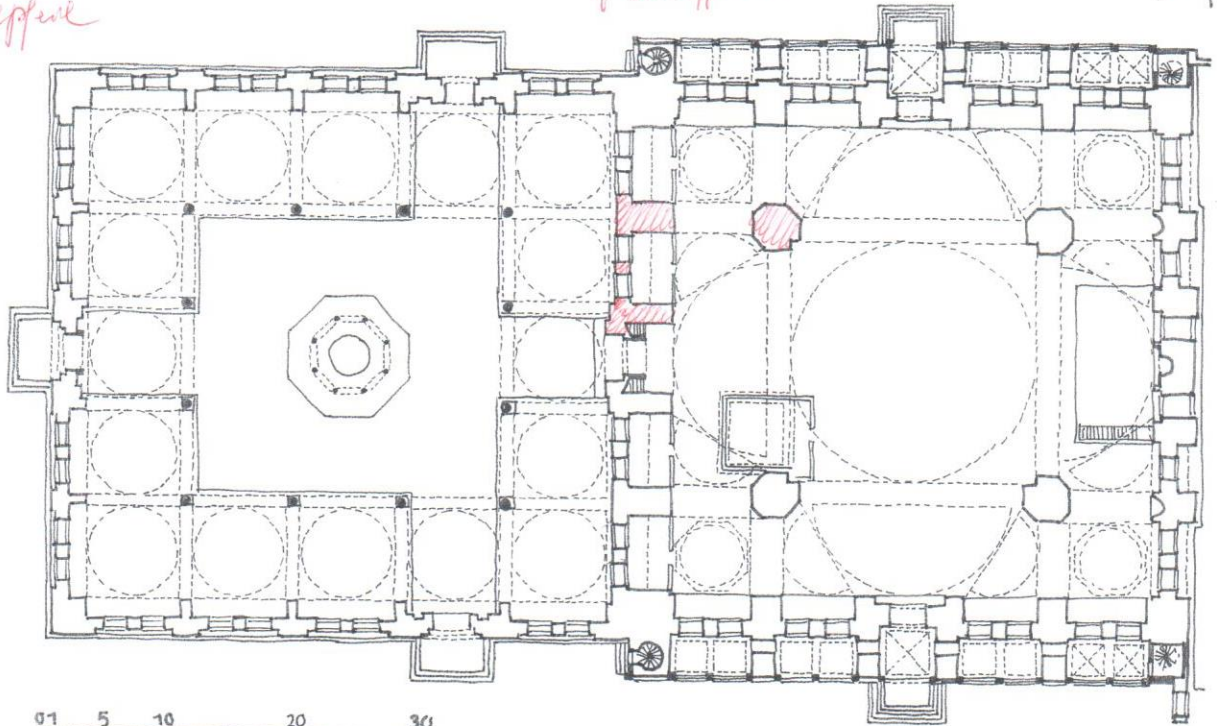

0 5 10 20 30 M

10/15

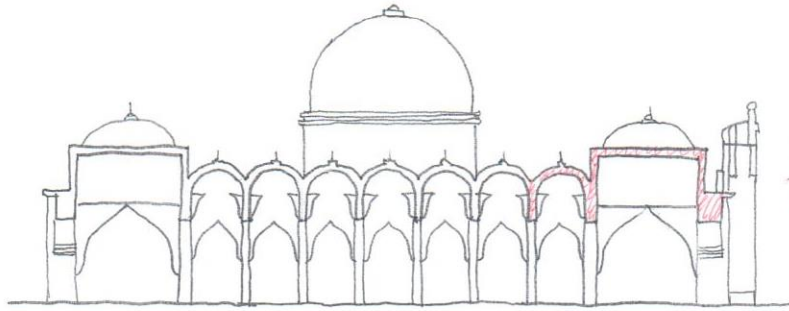

f. Schnaffieren

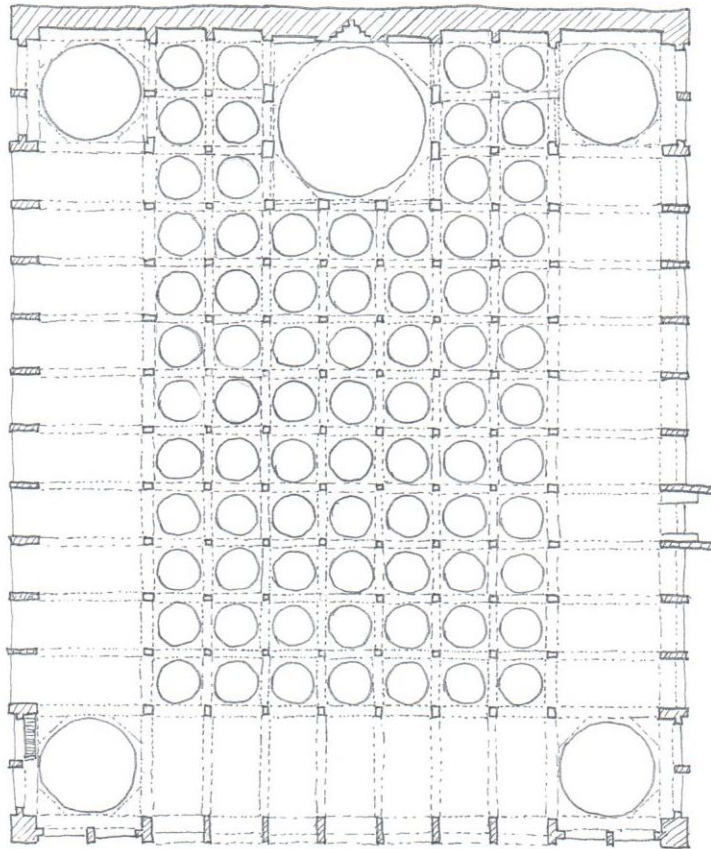

f. Nordpfeiler

FREITAGSMOSCHEE, GULBARGA 1367 N. CHR.

f. Maßstab 9/15

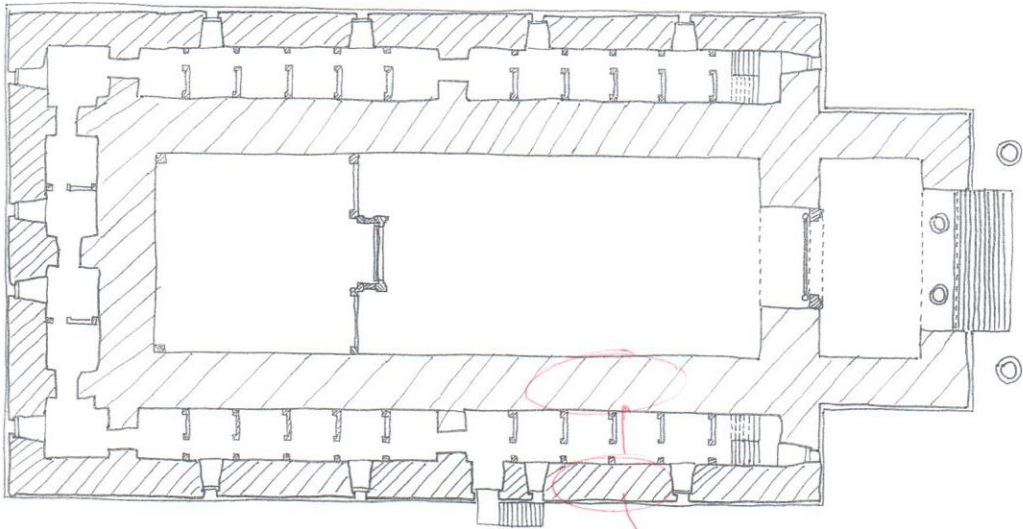
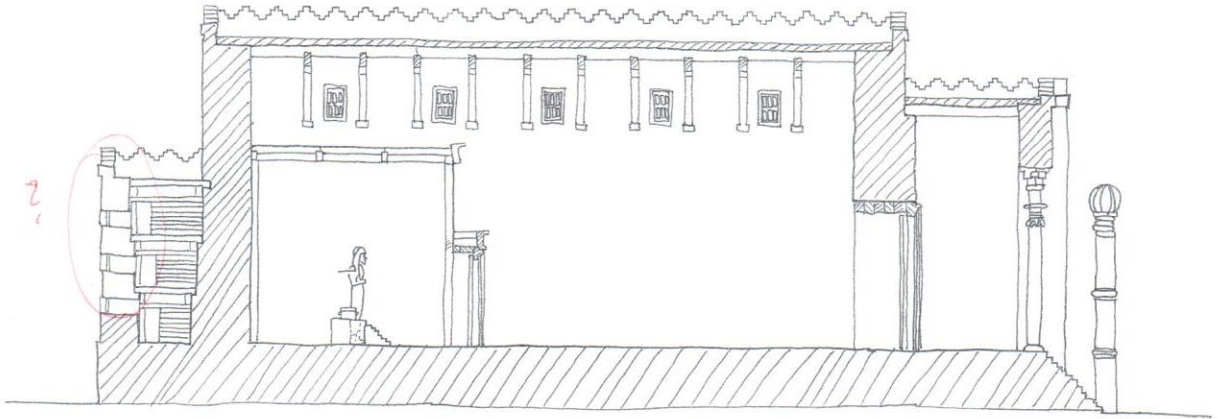

H Maßstab

"Schwaffen" mit Mängeln!

SALOMONISCHER TEMPEL, JERUSALEM 950 v. CHR

~

9/15

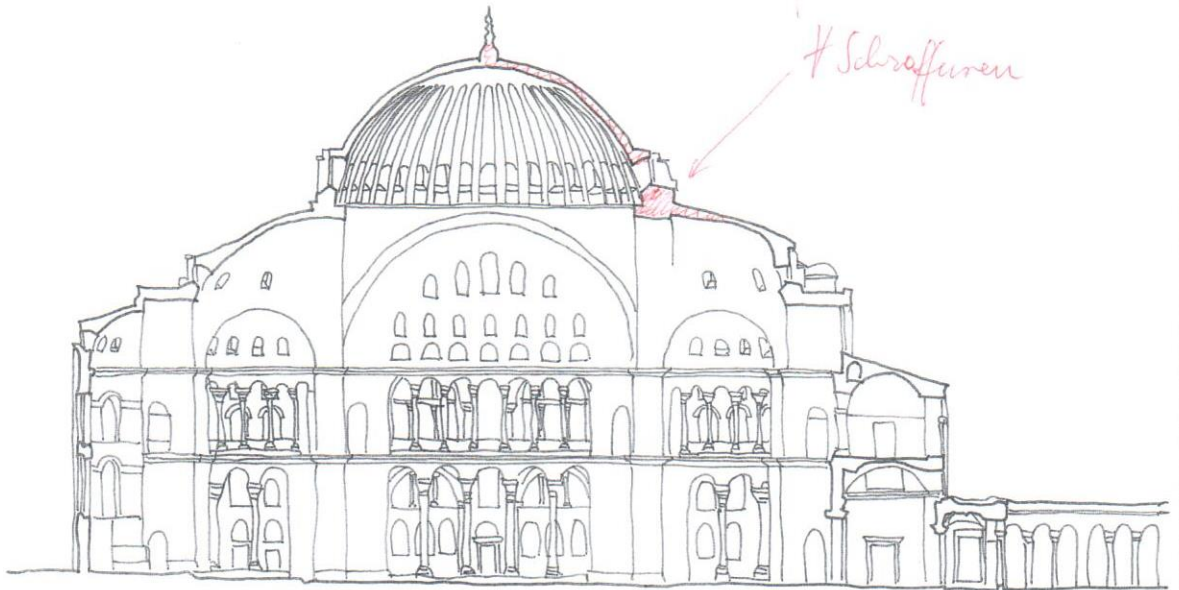
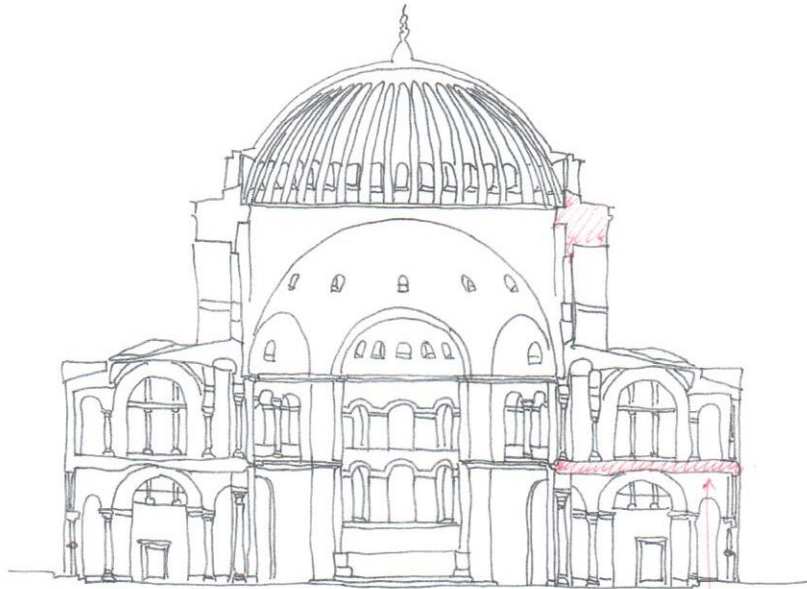

Schraffuren

Konstantinopel Hagia Sophia
532 - 537

Jahr
Maßstab



N
9/15

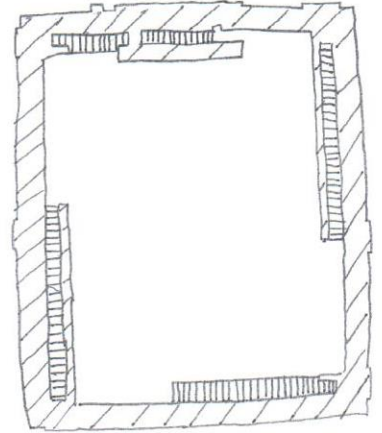
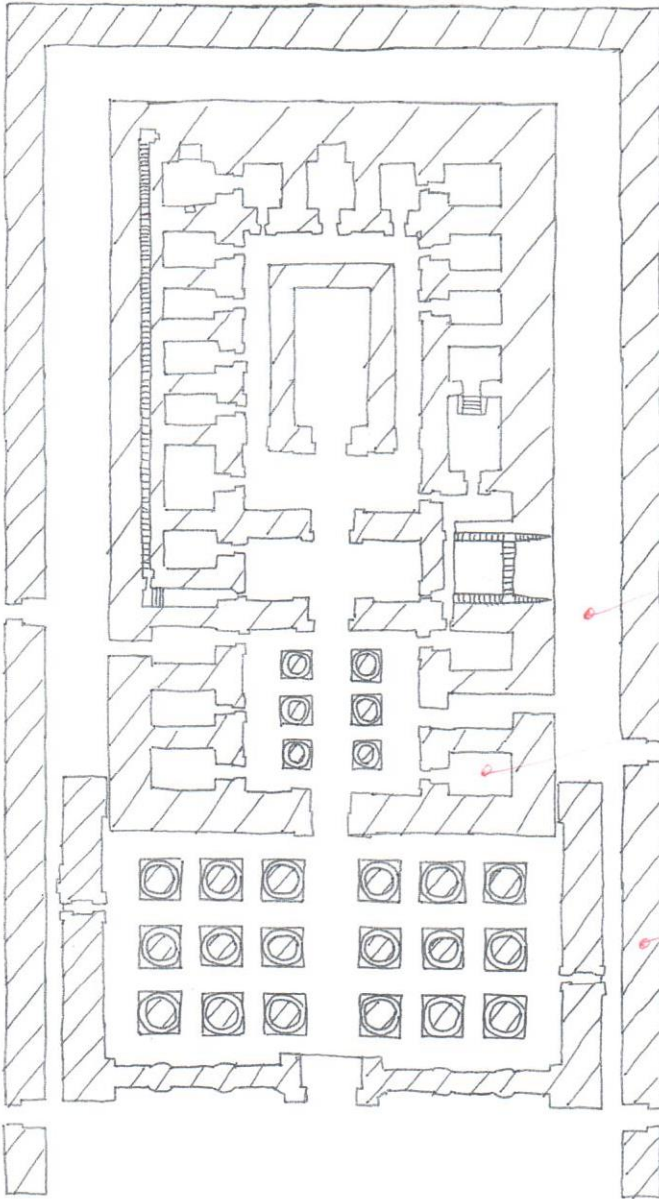

Bereich für

Bereich überdeckt

Prinzip bei Schroffus
(zu wenig Dichte)

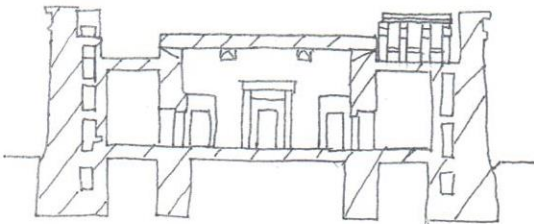

+ Nordpfeiler

+ Maßstab

✓

HATHOR-TEMPEL, DENDERA, ÄGYPTEN, 54 v. CHR. - 60 N. CHR.

8/15

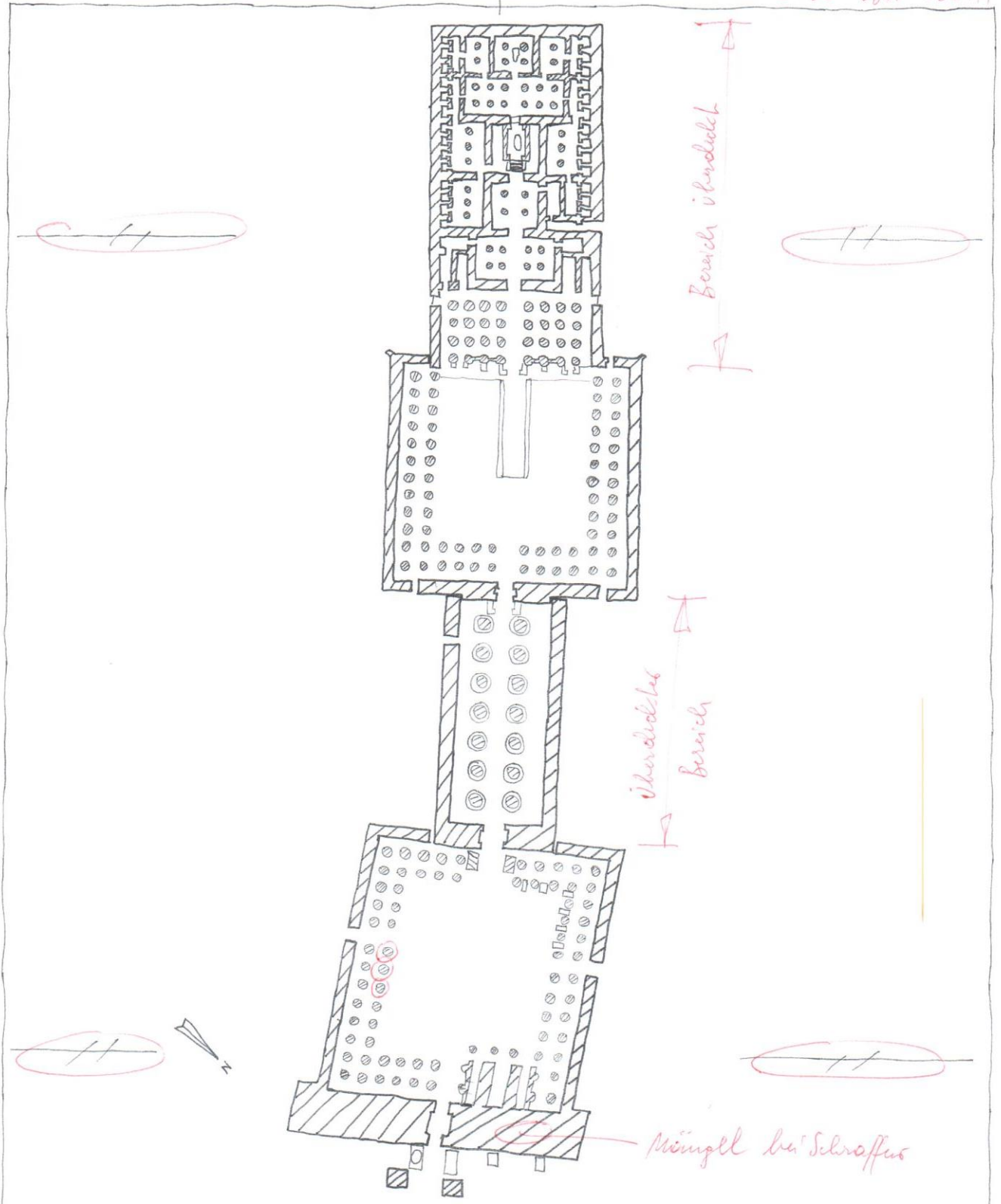

AMUN-TEMPEL IN LUXOR (THEBEN), ÄGYPTEN, 1500 - 1220 v. CHR.

8/15

GGPI-

43mm

25mm



SCHNITT

Schraffur

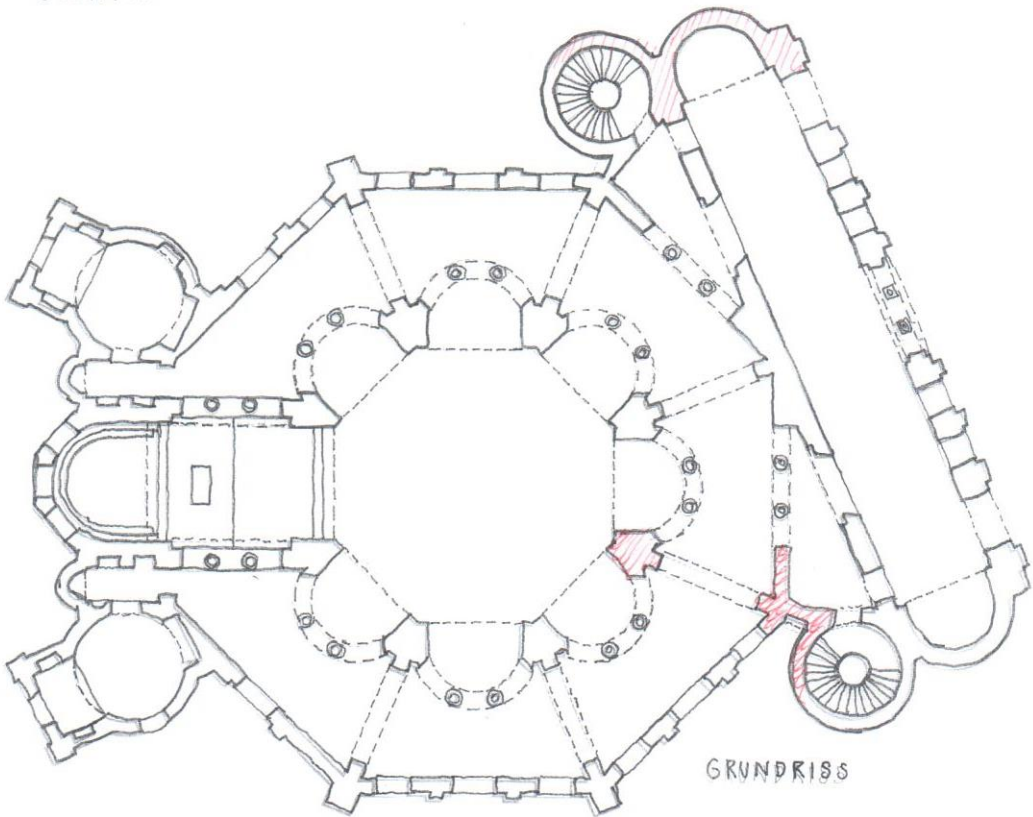

GRUNDRISS



530-547 N. CHR.
SAN VITALE, RAVENNA

✓
8/15

1KHA 972043/14 2009/2010

CELEBICIT

Zur Beachtung:

- Gewähltes Thema: 1. Lehnstuhl 2. Turm 3. Brücke 4. Tunnel
- Vorlageblatt auf A3 - insoweit durchgezogen

Verantwortl. Abgabetermin: 1999, Zimmer 220, Lehrstuhl für...

HAGIA IRENE, KONSTANTINOPEL 532 - 740 N. CHR.

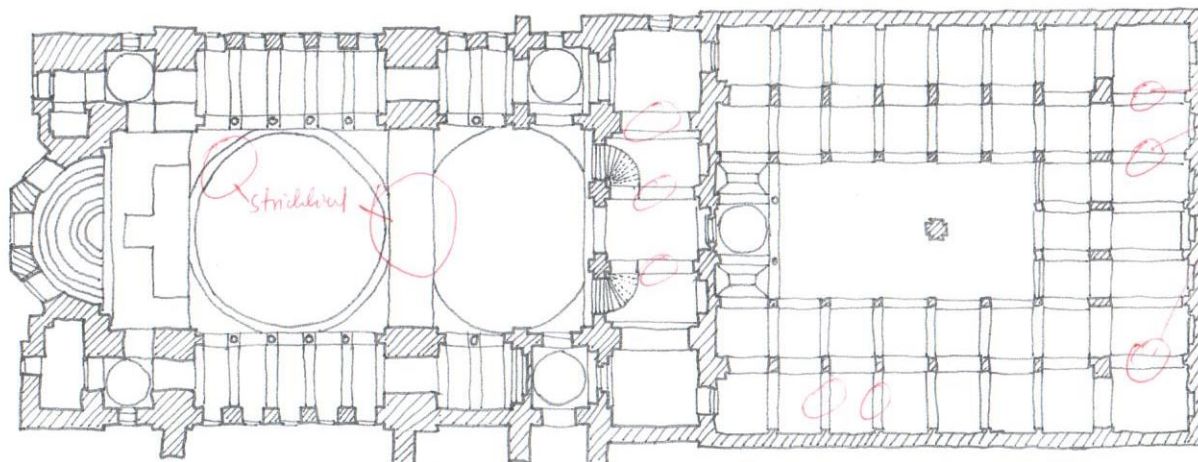

Stridbrud!

Mängel in d. Darstellung

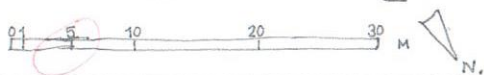

Peter Onitsch

8/15

NAME